



Satisfy Every

Customer By Our Professional Spirit

FEATURE

FEATURE OF PLUG AND SOCKET

STANDARD CONNECTOR



Connector with double screw type terminals, the cable wire stripping placed below the terminal, tighten the bolts first one, good pretension, then release the cable conductors, free tightened. Such a standard design, assembly is simple, simple, safe, and durable.

STANDARD PLUG



Depending on the polarity of the connecting cable, customers can freely choose the cable wiring, you can not import the cable core wire nuts, you can use the cable core wire nuts imported. Selective and flexible, there is no security risk. Plug design economical and practical, to meet customer's operational requirements.



- Socket terminal housing high-temperature resistant
- The diameter of cable for 63A is 36.5mm, 125A is 50mm
- The terminal of 125A are torsion terminal
- Can be inserted with big diameter cable
- Without cable wiring cap
- Contact pressure equalization
- Excellent conductive properties



- 16A, 32A, 63A Connector use soft contact technology
- Superior insertion and retention performance
- Superior mechanical properties and electrical properties



- Excellent contact, loosen the tail bolts to install easily

PARAMETER

PROTECTION RATINGS

Protection Against Solids		Protection Against Liquids		Protection Against Impact	
IP	Testing	IP	Testing	IK	Testing
0	No Protection	0	No Protection	00	No Protection
1	Protected against solid objects equal to or greater than 50mm diameter (eg accidents/contact with hand)	1	Protected against drops of water falling vertically	1	Impact of 0.7J
2	Protected against solid objects equal to or greater than 12mm diameter (eg contact with finger)	2	Protected against drops of water falling at up to 15 degree from the vertical	2	Impact of 1J
3	Protected against solid objects equal to or greater than 2.5mm diameter (eg tools and wires)	3	Protected against spraying water falling at up to 60 degree from the vertical	3	Impact of 2J
4	Protected against solid objects equal to or greater than 1mm diameter (eg wires)	4	Protected against splashing water from all directions	4	Impact of 5J
5	Protected against quantities of dust	5	Protected against jets of water from all directions	5	Impact of 10J
6	Completely protected against dust	6	Protected against jets of water of similar force to heavy seas	6	Impact of 20J
		7	Protected against the effects of immersion at 5cm below surface of water		
		8	Protected against the effects of continuous immersion		

According to the 100th part of VDE0470
 *The protection degree of external operation of electrical equipment to the external mechanical damage (IK code) IK code represent the protection degree of the shell against mechanical impact.
 IK code: Impact energy/joules



Satisfy Every

Customer By Our Professional Spirit

◆Products that meet the German industry standard DIN VDE 0623, European / International Standard EN/IEC 60309-1/2 For other voltages and frequencies, please contact us for further information.

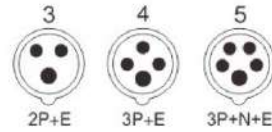

※ The picture is for reference only.

Appellation	Code	Normal Current	Earth contact Position	Normal Voltage	No.poles	Protection Degree
Plug	FT-CEE-013-4	16A	4h	110-130V~	2P+E	IP44
Plug	FT-CEE-023-4	32A	4h	110-130V~	2P+E	IP44

Size(mm)						Cable nominal cross section area
Type	a	b	c	Φ		
FT-CEE-013-4	59	51	122	6		1-2.5
FT-CEE-023-4	75	64	136	8		2.5-6



※ The picture is for reference only.

Appellation	Code	Normal Current	Earth contact Position	Normal Voltage	No.poles	Protection Degree
Plug	FT-CEE-033-4	63A	4h	100-130V~	2P+E	IP67

Size(mm)						Cable nominal cross section area
Type	a	b	c	Φ		
FT-CEE-033-4	108	108	230	16		6-16



Appellation	Code	Normal Current	Earth contact Position	Normal Voltage	No.poles	Protection Degree
Plug	FT-CEE-013	16A	6h	220-250V~	2P+E	IP44
Plug	FT-CEE-023	32A	6h	220-250V~	2P+E	IP44

Size(mm)						Cable nominal cross section area
Type	a	b	c	Φ		
FT-CEE-013	59	51	122	6		1-2.5
FT-CEE-023	75	64	136	8		2.5-6



Appellation	Code	Normal Current	Earth contact Position	Normal Voltage	No.poles	Protection Degree
Plug	FT-CEE-033	63A	6h	220-250V~	2P+E	IP67

Size(mm)						Cable nominal cross section area
Type	a	b	c	Φ		
FT-CEE-033	108	108	230	16		6-16



Appellation	Code	Normal Current	Earth contact Position	Normal Voltage	No.poles	Protection Degree
Plug	FT-CEE-014	16A	6h	380-415V~	3P+E	IP44
Plug	FT-CEE-024	32A	6h	380-415V~	3P+E	IP44

Size(mm)						Cable nominal cross section area
Type	a	b	c	Φ		
FT-CEE-014	65	55	122	6		1-2.5
FT-CEE-024	75	64	136	8		2.5-6



Appellation	Code	Normal Current	Earth contact Position	Normal Voltage	No.poles	Protection Degree
Plug	FT-CEE-034	63A	6h	380-415V~	3P+E	IP67

Size(mm)						Cable nominal cross section area
Type	a	b	c	Φ		
FT-CEE-034	108	108	230	16		6-16



Appellation	Code	Normal Current	Earth contact Position	Normal Voltage	No.poles	Protection Degree
Plug	FT-CEE-015	16A	6h	220-380V~ 240-415V~	3P+N+E	IP44
Plug	FT-CEE-025	32A	6h	220-380V~ 240-415V~	3P+N+E	IP44

Size(mm)						Cable nominal cross section area
Type	a	b	c	Φ		
FT-CEE-015	72	64	130	8		1-2.5
FT-CEE-025	84	70	143	8		2.5-6



Appellation	Code	Normal Current	Earth contact Position	Normal Voltage	No.poles	Protection Degree
Plug	FT-CEE-035	63A	6h	220-380V~ 240-415V~	3P+N+E	IP67

Size(mm)						Cable nominal cross section area
Type	a	b	c	Φ		
FT-CEE-035	108	108	230	16		6-16



Satisfy Every

Customer By Our Professional Spirit



※ The picture is for reference only.

Appellation	Code	Normal Current	Earth contact Position	Normal Voltage	No.poles	Protection Degree
Socket	FT-CEE-113-4	16A	4h	110-130V~	2P+E	IP44
Socket	FT-CEE-123-4	32A	4h	110-130V~	2P+E	IP44

Size(mm)				Cable nominal cross section area
Type	a	b	c	
FT-CEE-113-4	90	71	135	1-2.5
FT-CEE-123-4	100	71	151	2.5-6

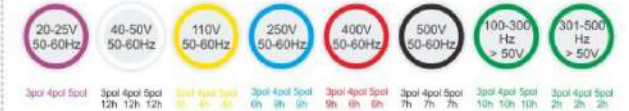
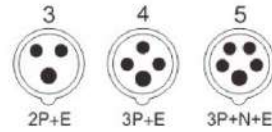

※ The picture is for reference only.

Appellation	Code	Normal Current	Earth contact Position	Normal Voltage	No.poles	Protection Degree
Socket	FT-CEE-133-4	63A	4h	100-130V~	2P+E	IP67

Size(mm)				Cable nominal cross section area
Type	a	b	c	
FT-CEE-133-4	133	108	310	6-25



Appellation	Code	Normal Current	Earth contact Position	Normal Voltage	No.poles	Protection Degree
Socket	FT-CEE-113	16A	6h	220-250V~	2P+E	IP44
Socket	FT-CEE-123	32A	6h	220-250V~	2P+E	IP44

Size(mm)				Cable nominal cross section area
Type	a	b	c	
FT-CEE-113	90	71	135	1-2.5
FT-CEE-123	100	71	151	2.5-6



Appellation	Code	Normal Current	Earth contact Position	Normal Voltage	No.poles	Protection Degree
Socket	FT-CEE-133	63A	6h	220-250V~	2P+E	IP67

Size(mm)				Cable nominal cross section area
Type	a	b	c	
FT-CEE-133	133	108	310	6-25



Appellation	Code	Normal Current	Earth contact Position	Normal Voltage	No.poles	Protection Degree
Socket	FT-CEE-114	16A	6h	380-415V~	3P+E	IP44
Socket	FT-CEE-124	32A	6h	380-415V~	3P+E	IP44

Size(mm)				Cable nominal cross section area
Type	a	b	c	
FT-CEE-114	92	71	140	1-2.5
FT-CEE-124	102	71	151	2.5-6



Appellation	Code	Normal Current	Earth contact Position	Normal Voltage	No.poles	Protection Degree
Socket	FT-CEE-134	63A	6h	380-415V~	3P+E	IP67

Size(mm)				Cable nominal cross section area
Type	a	b	c	
FT-CEE-134	133	108	310	6-25



Appellation	Code	Normal Current	Earth contact Position	Normal Voltage	No.poles	Protection Degree
Socket	FT-CEE-115	16A	6h	220-380V~ 240-415V~	3P+N+E	IP44
Socket	FT-CEE-125	32A	6h	220-380V~ 240-415V~	3P+N+E	IP44

Size(mm)				Cable nominal cross section area
Type	a	b	c	
FT-CEE-115	100	71	131	1-2.5
FT-CEE-125	109	71	152	2.5-6



Appellation	Code	Normal Current	Earth contact Position	Normal Voltage	No.poles	Protection Degree
Socket	FT-CEE-135	63A	6h	220-380V~ 240-415V~	3P+N+E	IP67

Size(mm)				Cable nominal cross section area
Type	a	b	c	
FT-CEE-135	133	108	310	6-25

◆Products that meet the German industry standard DIN VDE 0623, European / International Standard ENIEC 60309-1/2 For other voltages and frequencies, please contact us for further information.



Satisfy Every

Customer By Our Professional Spirit



※ The picture is for reference only.

Appellation	Code	Normal Current	Earth contact Position	Normal Voltage	No.poles	Protection Degree
Coupler	FT-CEE-213-4	16A	4h	100-130V~	2P+E	IP44
Coupler	FT-CEE-223-4	32A	4h	100-130V~	2P+E	IP44

Size(mm)						Cable nominal cross section area
Type	a	b	c	Φ		
FT-CEE-213-4	72	51	132	6		1-2.5
FT-CEE-223-4	92	64	146	8		2.5-6



Appellation	Code	Normal Current	Earth contact Position	Normal Voltage	No.poles	Protection Degree
Coupler	FT-CEE-213	16A	6h	220-250V~	2P+E	IP44
Coupler	FT-CEE-223	32A	6h	220-250V~	2P+E	IP44

Size(mm)						Cable nominal cross section area
Type	a	b	c	Φ		
FT-CEE-213	72	51	132	6		1-2.5
FT-CEE-223	92	64	146	8		2.5-6



Appellation	Code	Normal Current	Earth contact Position	Normal Voltage	No.poles	Protection Degree
Coupler	FT-CEE-214	16A	6h	380-415V~	3P+E	IP44
Coupler	FT-CEE-224	32A	6h	380-415V~	3P+E	IP44

Size(mm)						Cable nominal cross section area
Type	a	b	c	Φ		
FT-CEE-214	78	55	132	6		1-2.5
FT-CEE-224	92	64	146	8		2.5-6



Appellation	Code	Normal Current	Earth contact Position	Normal Voltage	No.poles	Protection Degree
Coupler	FT-CEE-215	16A	6h	220-380V~ 240-415V~	3P+N+E	IP44
Coupler	FT-CEE-225	32A	6h	220-380V~ 240-415V~	3P+N+E	IP44

Size(mm)						Cable nominal cross section area
Type	a	b	c	Φ		
FT-CEE-215	92	63	139	6		1-2.5
FT-CEE-225	101	70	154	8		2.5-6

◆Products that meet the German industry standard DIN VDE 0623, European / International Standard ENIEC 60309-1/2 For other voltages and frequencies, please contact us for further information.

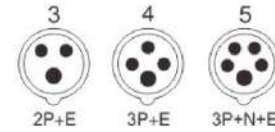

※ The picture is for reference only.

Appellation	Code	Normal Current	Earth contact Position	Normal Voltage	No.poles	Protection Degree
Coupler	FT-CEE-233-4	63A	4h	110-130V~	2P+E	IP67

Size(mm)						Cable nominal cross section area
Type	a	b	c			
FT-CEE-233-4	116	108	245			6-16



Appellation	Code	Normal Current	Earth contact Position	Normal Voltage	No.poles	Protection Degree
Coupler	FT-CEE-233	63A	6h	220-250V~	2P+E	IP67

Size(mm)						Cable nominal cross section area
Type	a	b	c			
FT-CEE-233	116	108	245			6-16



Appellation	Code	Normal Current	Earth contact Position	Normal Voltage	No.poles	Protection Degree
Coupler	FT-CEE-234	63A	6h	380-415V~	3P+E	IP67

Size(mm)						Cable nominal cross section area
Type	a	b	c			
FT-CEE-234	116	108	245			6-16



Appellation	Code	Normal Current	Earth contact Position	Normal Voltage	No.poles	Protection Degree
Coupler	FT-CEE-235	63A	6h	220-380V~ 240-415V~	3P+N+E	IP67

Size(mm)						Cable nominal cross section area
Type	a	b	c			
FT-CEE-235	116	108	245			6-16



Satisfy Every

Customer By Our Professional Spirit



※ The picture is for reference only.

Appellation	Code	Normal Current	Earth contact Position	Normal Voltage	No.poles	Protection Degree
Socket	FT-CEE-313-4	16A	4h	110-130V~	2P+E	IP44
Socket	FT-CEE-323-4	32A	4h	110-130V~	2P+E	IP44

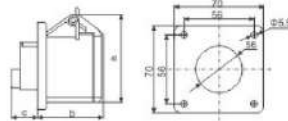

Size(mm)				Cable nominal cross section area
Type	a	b	c	
FT-CEE-313-4	78	46	27	1-2.5
FT-CEE-323-4	88	56	32	2.5-6

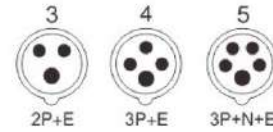

※ The picture is for reference only.

Appellation	Code	Normal Current	Earth contact Position	Normal Voltage	No.poles	Protection Degree
Socket	FT-CEE-333-4	63A	4h	110-130V~	2P+E	IP67

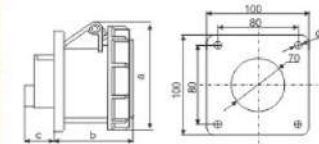

Size(mm)				Cable nominal cross section area
Type	a	b	c	
FT-CEE-333-4	117	85	57	6-16



Appellation	Code	Normal Current	Earth contact Position	Normal Voltage	No.poles	Protection Degree
Socket	FT-CEE-313	16A	6h	220-250V~	2P+E	IP44
Socket	FT-CEE-323	32A	6h	220-250V~	2P+E	IP44

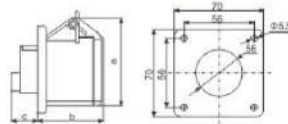

Size(mm)				Cable nominal cross section area
Type	a	b	c	
FT-CEE-313	78	46	27	1-2.5
FT-CEE-323	88	56	32	2.5-6



Appellation	Code	Normal Current	Earth contact Position	Normal Voltage	No.poles	Protection Degree
Socket	FT-CEE-333	63A	6h	220-250V~	2P+E	IP67

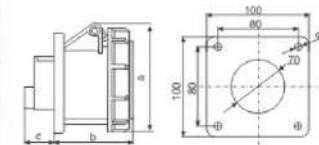

Size(mm)				Cable nominal cross section area
Type	a	b	c	
FT-CEE-333	117	85	57	6-16



Appellation	Code	Normal Current	Earth contact Position	Normal Voltage	No.poles	Protection Degree
Socket	FT-CEE-314	16A	6h	380-415V~	3P+E	IP44
Socket	FT-CEE-324	32A	6h	380-415V~	3P+E	IP44

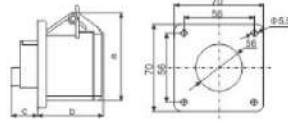

Size(mm)				Cable nominal cross section area
Type	a	b	c	
FT-CEE-314	78	50	25	1-2.5
FT-CEE-324	88	56	32	2.5-6



Appellation	Code	Normal Current	Earth contact Position	Normal Voltage	No.poles	Protection Degree
Socket	FT-CEE-334	63A	6h	380-415V~	3P+E	IP67

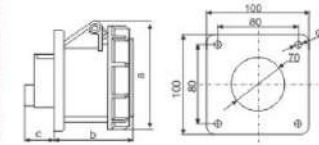

Size(mm)				Cable nominal cross section area
Type	a	b	c	
FT-CEE-334	117	85	57	6-16



Appellation	Code	Normal Current	Earth contact Position	Normal Voltage	No.poles	Protection Degree
Socket	FT-CEE-315	16A	6h	220-380V~ 240-415V~	3P+N+E	IP44
Socket	FT-CEE-325	32A	6h	220-380V~ 240-415V~	3P+N+E	IP44

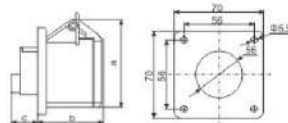

Size(mm)				Cable nominal cross section area
Type	a	b	c	
FT-CEE-315	88	48	25	1-2.5
FT-CEE-325	98	62	28	2.5-6



Appellation	Code	Normal Current	Earth contact Position	Normal Voltage	No.poles	Protection Degree
Socket	FT-CEE-335	63A	6h	220-380V~ 240-415V~	3P+N+E	IP67

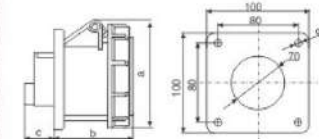

Size(mm)				Cable nominal cross section area
Type	a	b	c	
FT-CEE-335	117	85	57	6-16

◆Products that meet the German industry standard DIN VDE 0623, European / International Standard ENIEC 60309-1/2 For other voltages and frequencies, please contact us for further information.



Satisfy Every

Customer By Our Professional Spirit

◆Products that meet the German industry standard DIN VDE 0623, European / International Standard ENIEC 60309-1/2 For other voltages and frequencies, please contact us for further information.

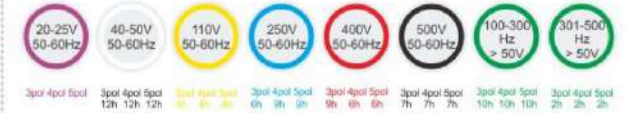
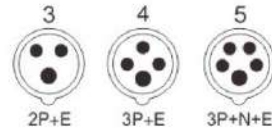

※ The picture is for reference only.

Appellation	Code	Normal Current	Earth contact Position	Normal Voltage	No.poles	Protection Degree
Socket	FT-CEE-413-4	16A	4h	110-130V~	2P+E	IP44

Size(mm)		Cable nominal cross section area		
Type	a	b	c	
FT-CEE-413-4	74	72	45	1-2.5



※ The picture is for reference only.

Appellation	Code	Normal Current	Earth contact Position	Normal Voltage	No.poles	Protection Degree
Socket	FT-CEE-423-4	32A	4h	110-130V~	2P+E	IP44

Size(mm)		Cable nominal cross section area		
Type	a	b	c	
FT-CEE-423-4	96	92	52	2.5-6



Appellation	Code	Normal Current	Earth contact Position	Normal Voltage	No.poles	Protection Degree
Socket	FT-CEE-413	16A	6h	220-250V~	2P+E	IP44

Size(mm)		Cable nominal cross section area		
Type	a	b	c	
FT-CEE-413	74	72	45	1-2.5



Appellation	Code	Normal Current	Earth contact Position	Normal Voltage	No.poles	Protection Degree
Socket	FT-CEE-423	32A	6h	220-250V~	2P+E	IP44

Size(mm)		Cable nominal cross section area		
Type	a	b	c	
FT-CEE-423	96	92	52	2.5-6



Appellation	Code	Normal Current	Earth contact Position	Normal Voltage	No.poles	Protection Degree
Socket	FT-CEE-414	16A	6h	380-415V~	3P+E	IP44

Size(mm)		Cable nominal cross section area		
Type	a	b	c	
FT-CEE-414	84	73	46	1-2.5



Appellation	Code	Normal Current	Earth contact Position	Normal Voltage	No.poles	Protection Degree
Socket	FT-CEE-424	32A	6h	380-415V~	3P+E	IP44

Size(mm)		Cable nominal cross section area		
Type	a	b	c	
FT-CEE-424	96	92	52	2.5-6



Appellation	Code	Normal Current	Earth contact Position	Normal Voltage	No.poles	Protection Degree
Socket	FT-CEE-415	16A	6h	220-380V~ 240-415V~	3P+N+E	IP44

Size(mm)		Cable nominal cross section area		
Type	a	b	c	
FT-CEE-415	90	77	49	1-2.5



Appellation	Code	Normal Current	Earth contact Position	Normal Voltage	No.poles	Protection Degree
Socket	FT-CEE-425	32A	6h	220-380V~ 240-415V~	3P+N+E	IP44

Size(mm)		Cable nominal cross section area		
Type	a	b	c	
FT-CEE-425	102	95	51	2.5-6



Satisfy Every

Customer By Our Professional Spirit



※ The picture is for reference only.

Appellation	Code	Normal Current	Earth contact Position	Normal Voltage	No.poles	Protection Degree
Plug	FT-CEE-513-4	16A	4h	110-130V~	2P+E	IP44
Plug	FT-CEE-523-4	32A	4h	110-130V~	2P+E	IP44

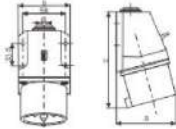

Size(mm)		a	b	c	Cable nominal cross section area
Type					
	FT-CEE-513-4	78	71	131	1-2.5
	FT-CEE-523-4	83	71	140	2.5-6



Appellation	Code	Normal Current	Earth contact Position	Normal Voltage	No.poles	Protection Degree
Plug	FT-CEE-513	16A	6h	220-250V~	2P+E	IP44
Plug	FT-CEE-523	32A	6h	220-250V~	2P+E	IP44

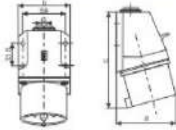

Size(mm)		a	b	c	Cable nominal cross section area
Type					
	FT-CEE-513	78	71	131	1-2.5
	FT-CEE-523	83	71	140	2.5-6



Appellation	Code	Normal Current	Earth contact Position	Normal Voltage	No.poles	Protection Degree
Plug	FT-CEE-514	16A	6h	380-415V~	3P+E	IP44
Plug	FT-CEE-524	32A	6h	380-415V~	3P+E	IP44

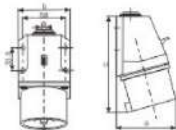

Size(mm)		a	b	c	Cable nominal cross section area
Type					
	FT-CEE-514	78	71	131	1-2.5
	FT-CEE-524	83	71	140	2.5-6



Appellation	Code	Normal Current	Earth contact Position	Normal Voltage	No.poles	Protection Degree
Plug	FT-CEE-515	16A	6h	220-380V~ 240-415V~	3P+N+E	IP44
Plug	FT-CEE-525	32A	6h	220-380V~ 240-415V~	3P+N+E	IP44

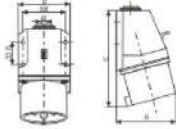

Size(mm)		a	b	c	Cable nominal cross section area
Type					
	FT-CEE-515	80	71	131	1-2.5
	FT-CEE-525	87	71	142	2.5-6

◆Products that meet the German industry standard DIN VDE 0623, European / International Standard ENIEC 60309-1/2 For other voltages and frequencies, please contact us for further information.

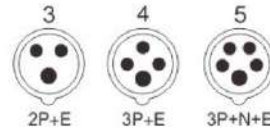

※ The picture is for reference only.

Appellation	Code	Normal Current	Earth contact Position	Normal Voltage	No.poles	Protection Degree
Plug	FT-CEE-613-4	16A	4h	110-130V~	2P+E	IP44
Plug	FT-CEE-623-4	32A	4h	110-130V~	2P+E	IP44

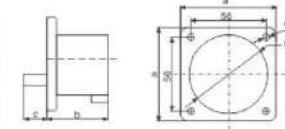

Size(mm)		a	b	c	Cable nominal cross section area
Type					
	FT-CEE-613-4	70	41	24	1-2.5
	FT-CEE-623-4	70	50	28	2.5-6



Appellation	Code	Normal Current	Earth contact Position	Normal Voltage	No.poles	Protection Degree
Plug	FT-CEE-613	16A	6h	220-250V~	2P+E	IP44
Plug	FT-CEE-623	32A	6h	220-250V~	2P+E	IP44

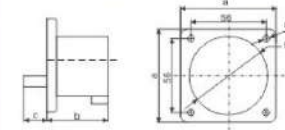

Size(mm)		a	b	c	Cable nominal cross section area
Type					
	FT-CEE-613	70	41	24	1-2.5
	FT-CEE-623	70	50	28	2.5-6



Appellation	Code	Normal Current	Earth contact Position	Normal Voltage	No.poles	Protection Degree
Plug	FT-CEE-614	16A	6h	380-415V~	3P+E	IP44
Plug	FT-CEE-624	32A	6h	380-415V~	3P+E	IP44

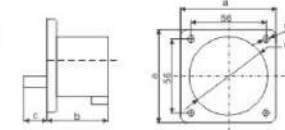

Size(mm)		a	b	c	Cable nominal cross section area
Type					
	FT-CEE-614	70	41	24	1-2.5
	FT-CEE-624	70	50	28	2.5-6



Appellation	Code	Normal Current	Earth contact Position	Normal Voltage	No.poles	Protection Degree
Plug	FT-CEE-615	16A	6h	220-380V~ 240-415V~	3P+N+E	IP44
Plug	FT-CEE-625	32A	6h	220-380V~ 240-415V~	3P+N+E	IP44

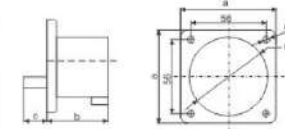

Size(mm)		a	b	c	Cable nominal cross section area
Type					
	FT-CEE-615	70	41	24	1-2.5
	FT-CEE-625	70	51	29	2.5-6



Satisfy Every

Customer By Our Professional Spirit



※ The picture is for reference only.

Appellation	Code	Normal Current	Earth contact Position	Normal Voltage	No.poles	Protection Degree
Plug	FT-CEE-013L-4	16A	4h	110-130V~	2P+E	IP44
Plug	FT-CEE-023L-4	32A	4h	110-130V~	2P+E	IP44

Size(mm)						Cable nominal cross section area
Type	a	b	c	Φ		
FT-CEE-013L-4	59	51	141	6	1-2.5	
FT-CEE-023L-4	75	64	167	8	2.5-6	



Appellation	Code	Normal Current	Earth contact Position	Normal Voltage	No.poles	Protection Degree
Plug	FT-CEE-013L	16A	6h	220-250V~	2P+E	IP44
Plug	FT-CEE-023L	32A	6h	220-250V~	2P+E	IP44

Size(mm)						Cable nominal cross section area
Type	a	b	c	Φ		
FT-CEE-013L	59	51	141	6	1-2.5	
FT-CEE-023L	75	64	167	8	2.5-6	



Appellation	Code	Normal Current	Earth contact Position	Normal Voltage	No.poles	Protection Degree
Plug	FT-CEE-014L	16A	6h	380-415V~	3P+E	IP44
Plug	FT-CEE-024L	32A	6h	380-415V~	3P+E	IP44

Size(mm)						Cable nominal cross section area
Type	a	b	c	Φ		
FT-CEE-014L	65	55	141	6	1-2.5	
FT-CEE-024L	75	64	167	8	2.5-6	



Appellation	Code	Normal Current	Earth contact Position	Normal Voltage	No.poles	Protection Degree
Plug	FT-CEE-015L	16A	6h	220-380V~ 240-415V~	3P+N+E	IP44
Plug	FT-CEE-025L	32A	6h	220-380V~ 240-415V~	3P+N+E	IP44

Size(mm)						Cable nominal cross section area
Type	a	b	c	Φ		
FT-CEE-015L	72	64	160	8	1-2.5	
FT-CEE-025L	84	70	174	8	2.5-6	

◆Products that meet the German industry standard DIN VDE 0623, European / International Standard ENIEC 60309-1/2 For other voltages and frequencies, please contact us for further information.

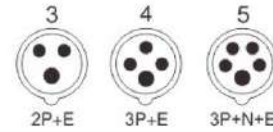

※ The picture is for reference only.

Appellation	Code	Normal Current	Earth contact Position	Normal Voltage	No.poles	Protection Degree
Socket	FT-CEE-113L-4	16A	4h	110-130V~	2P+E	IP44
Socket	FT-CEE-123L-4	32A	4h	110-130V~	2P+E	IP44

Size(mm)						Cable nominal cross section area
Type	a	b	c	Φ		
FT-CEE-113L-4	90	71	165		1-2.5	
FT-CEE-123L-4	100	71	179		2.5-6	



Appellation	Code	Normal Current	Earth contact Position	Normal Voltage	No.poles	Protection Degree
Socket	FT-CEE-113L	16A	6h	220-250V~	2P+E	IP44
Socket	FT-CEE-123L	32A	6h	220-250V~	2P+E	IP44

Size(mm)						Cable nominal cross section area
Type	a	b	c	Φ		
FT-CEE-113L	90	71	165		1-2.5	
FT-CEE-123L	100	71	179		2.5-6	



Appellation	Code	Normal Current	Earth contact Position	Normal Voltage	No.poles	Protection Degree
Socket	FT-CEE-114L	16A	6h	380-415V~	3P+E	IP44
Socket	FT-CEE-124L	32A	6h	380-415V~	3P+E	IP44

Size(mm)						Cable nominal cross section area
Type	a	b	c	Φ		
FT-CEE-114L	92	71	165		1-2.5	
FT-CEE-124L	102	71	179		2.5-6	



Appellation	Code	Normal Current	Earth contact Position	Normal Voltage	No.poles	Protection Degree
Socket	FT-CEE-115L	16A	6h	220-380V~ 240-415V~	3P+N+E	IP44
Socket	FT-CEE-125L	32A	6h	220-380V~ 240-415V~	3P+N+E	IP44

Size(mm)						Cable nominal cross section area
Type	a	b	c	Φ		
FT-CEE-115L	100	71	166		1-2.5	
FT-CEE-125L	109	71	180		2.5-6	



Satisfy Every

Customer By Our Professional Spirit

◆Products that meet the German industry standard DIN VDE 0623, European / International Standard ENIEC 60309-1/2 For other voltages and frequencies, please contact us for further information.

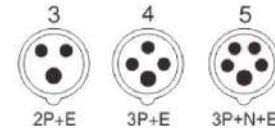

※ The picture is for reference only.

Appellation	Code	Normal Current	Earth contact Position	Normal Voltage	No.poles	Protection Degree
Coupler	FT-CEE-213L-4	16A	4h	100-130V~	2P+E	IP44
Coupler	FT-CEE-223L-4	32A	4h	100-130V~	2P+E	IP44

Size(mm)		a	b	c	Φ	Cable nominal cross section area
Type						
	FT-CEE-213L-4	72	51	151	6	1-2.5
	FT-CEE-223L-4	92	64	177	8	2.5-6



Appellation	Code	Normal current	Normal voltage	Number of poles	Protection degree
Plug	FT-CEE-012	16A	220-250V~	2P+E	IP44

Size(mm)		a	b	Cable nominal cross section area
Type				
	FT-CEE-012	40	96	1-2.5



Appellation	Code	Normal Current	Earth contact Position	Normal Voltage	No.poles	Protection Degree
Coupler	FT-CEE-213L	16A	6h	220-250V~	2P+E	IP44
Coupler	FT-CEE-223L	32A	6h	220-250V~	2P+E	IP44

Size(mm)		a	b	c	Φ	Cable nominal cross section area
Type						
	FT-CEE-213L	72	51	151	6	1-2.5
	FT-CEE-223L	92	64	177	8	2.5-6



Appellation	Code	Normal current	Normal voltage	Number of poles	Protection degree
Socket	FT-CEE-112	16A	220-250V~	2P+E	IP44

Size(mm)		a	b	c	Cable nominal cross section area
Type					
	FT-CEE-112	70	53	67	1-2.5



Appellation	Code	Normal Current	Earth contact Position	Normal Voltage	No.poles	Protection Degree
Coupler	FT-CEE-214L	16A	6h	380-415V~	3P+E	IP44
Coupler	FT-CEE-224L	32A	6h	380-415V~	3P+E	IP44

Size(mm)		a	b	c	Φ	Cable nominal cross section area
Type						
	FT-CEE-214L	78	55	151	6	1-2.5
	FT-CEE-224L	92	64	177	8	2.5-6



Appellation	Code	Normal current	Normal voltage	Number of poles	Protection degree
Coupler	FT-CEE-212	16A	220-250V~	2P+E	IP44

Size(mm)		a	b	c	Cable nominal cross section area
Type					
	FT-CEE-212	72	48	123	1-2.5



Appellation	Code	Normal Current	Earth contact Position	Normal Voltage	No.poles	Protection Degree
Coupler	FT-CEE-215L	16A	6h	220-380V~ 240-415V~	3P+N+E	IP44
Coupler	FT-CEE-225L	32A	6h	220-380V~ 240-415V~	3P+N+E	IP44

Size(mm)		a	b	c	Φ	Cable nominal cross section area
Type						
	FT-CEE-215L	92	63	169	6	1-2.5
	FT-CEE-225L	101	70	185	8	2.5-6



Appellation	Code	Normal current	Normal voltage	Number of poles	Protection degree
Socket	FT-CEE-312	16A	220-250V~	2P+E	IP44

Size(mm)		a	b	c	Cable nominal cross section area
Type					
	FT-CEE-312	63	43	25	1-2.5



Satisfy Every

Customer By Our Professional Spirit

★ MULTIPLE-OUTLET SOCKET

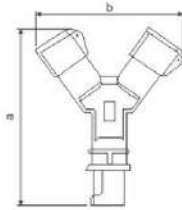

Code	Normal current	Earth contact position	Normal voltage	Number of poles	Protection degree	Size(mm)	
						a	b
FT-CEE-1012-3	16A	6h	220-240V~	2P+E	IP44	203	185
FT-CEE-1022-3	32A	6h	220-240V~	2P+E	IP44	285	255

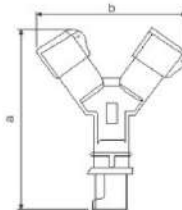

Code	Normal current	Earth contact position	Normal voltage	Number of poles	Protection degree	Size(mm)	
						a	b
FT-CEE-1012-4	16A	6h	380-415V~	3P+E	IP44	205	185
FT-CEE-1022-4	32A	6h	380-415V~	3P+E	IP44	285	255

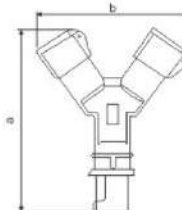

Code	Normal current	Earth contact position	Normal voltage	Number of poles	Protection degree	Size(mm)	
						a	b
FT-CEE-1012-5	16A	6h	220-380V~ 240-415V~	3P+N+E	IP44	265	240

◆Products that meet the German industry standard DIN VDE 0623, European / International Standard ENIEC 60309-1/2 For other voltages and frequencies, please contact us for further information.

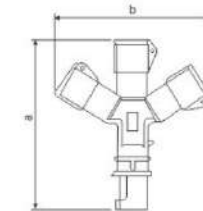
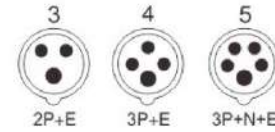

Code	Normal current	Earth contact position	Normal voltage	Number of poles	Protection degree	Size(mm)	
						a	b
FT-CEE-1013	16A	6h	220-240V~	2P+E	IP44	223	220
FT-CEE-1023	32A	6h	220-240V~	2P+E	IP44	318	305

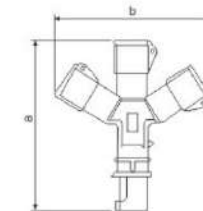

Code	Normal current	Earth contact position	Normal voltage	Number of poles	Protection degree	Size(mm)	
						a	b
FT-CEE-1014	16A	6h	380-415V~	3P+E	IP44	223	220
FT-CEE-1024	32A	6h	380-415V~	3P+E	IP44	318	305

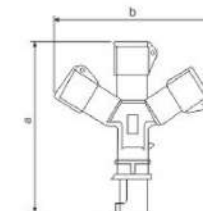

Code	Normal current	Earth contact position	Normal voltage	Number of poles	Protection degree	Size(mm)	
						a	b
FT-CEE-1015	16A	6h	220-380V~ 240-415V~	3P+N+E	IP44	305	295



Satisfy Every

Customer By Our Professional Spirit



Code	Normal current	Input	Output	Number of poles	Protection degree
FT-013X/213X	16A	220V	220V	2P+E	IP44



Code	Normal current	Input	Output	Number of poles	Protection degree
FT-0132/2132	16A	220V	220V	2P+E	IP67



Code	Normal current	Input	Output	Number of poles	Protection degree
FT-014X/214X	16A	380V	380V	3P+E	IP44



Code	Normal current	Input	Output	Number of poles	Protection degree
FT-0242/2242	32A	380-415V	380-415V	3P+E	IP67



Code	Qty	mm
FT-314X	2只	200 x 150 x 100



Code	Qty	mm
FT-313	3只	500 x 140 x 95



Code	Qty	mm
FT-3232	3只	500 x 140 x 95



Code	Qty	mm
FT-313X FT-3132	1只 2只	490 x 140 x 95

◆Products that meet the German industry standard DIN VDE 0623, European / International Standard ENIEC 60309-1/2 For other voltages and frequencies, please contact us for further information.

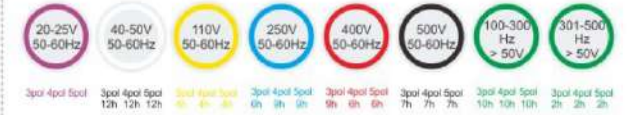
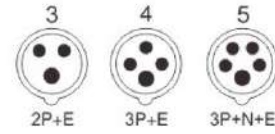

Code	FT-312	FT-313
Qty	2只	2只
mm	340 x 220 x 150	



Code	FT-312	FT-252
Qty	3只	2只
mm	380 x 280 x 130	



Code	FT-324X	FT-323X
Qty	3只	3只
mm	380 x 280 x 140	



Code	FT-1142	FT-1252
Qty	2只	2只
mm	520 x 300 x 160	



Code	Normal current	Earth contact position	Normal voltage	Number of poles	Protection degree
FT-10132	16A	6h	220-240V~	2P+E	IP67



Code	Qty
FT-313X	4只
FT-315X	4只
FT-3252	3只
FT-034	1只
FT-634	1只
mm	340 x 370 x 330



Code	Qty
FT-312	4只
FT-1252	4只
FT-015X	1只
mm	230 x 300 x 287